

www.southwestbluegrassclub.org

**In This Issue**

- Next Meeting ----- Page 1
- New & Renewing Members----- Page 1
- President's Message -----Page 2
- Masters Of Bluegrass Concert** -- Page 3
- Club News ----- Page 5 & 15
- Update and Request- for Nov 16-- Pg 6
- In Memory of Don Humphery ---- page 7
- Special Events Listings ----- Page 12
- Treasurer's Report for July ----Page 14
- Member Application, Ad rates – Pg --16



**SEE FLYER PAGE 8**

**COMPTON & GRIER**

October 3, 2013 7:00 pm  
1st United Methodist Church: Leonard Chapel  
800 W. 5th, Fort Worth, TX 76102  
\$20.00 pre-sale; \$25.00 door  
contact: robertjustinwalt@yahoo.com

**BIG CHANGE; NEXT MEETING is SATURDAY, October 12TH Noon to 4 pm** at the **"Just Off Main" coffee house** at 113 East Texas St, Grapevine, TX 76051.

**JAMMING from Noon to 4 pm -- No Potluck, Just a Short Meeting, then Jamming inside and Outside**

**Welcome New Members** – Linda Stewart -- **Thank You Renewing Members** – Clifford Woods, Dillard D. Graham, Gary Myers, John L. Payne, Paul Smith, Tommy Turner, Willie Morgan --

**Thank You for your Donation** – John L. Payne



**FIRST CLASS MAIL**

**RETURN SERVICE REQUESTED**

Dennis Hillery, Editor  
143 Pelican Cove Drive  
Rockwall, TX 75087

Send all changes of address to:  
Send change of address or correspondence to: [dhillery1@gmail.com](mailto:dhillery1@gmail.com)

**OFFICERS**

President - *Debbie Morrow* – 817 - 798-1334  
1st Vice President - *J. B. Baccus Jr.* – 972 - 790 - 4126  
2nd Vice President - *Bill Kline* – 903 - 337- 0950  
Treasurer - *Phyllis Hillery* – 972 – 306 - 5887  
Secretary - **VACANT**

**Directors**

*Brent Young* – 972 – 924 - 8188  
*Buz Busby* - 214-415-7818  
*Darwin Slaughter* – 972 - 977- 3027  
*Dennis Hillery* – 214 - 542 - 4402  
*Joe Morrow* - 817- 798-3900  
**Vacant -**

**STAFF**

**Editor** — Dennis Hillery – 214-542-4402, dhillery1@gmail.com

**Publisher**— Pam Dahl - 972-992-8041 - pameladahl@yahoo.com

**Registrar**— Jim Rozell - 972 530-6102 - jamesorozell@verizon.net

**Photographer**—**VACANT** -----**Webmaster**—**VACANT** -- webmaster@southwestbluegrassclub.org

**FROM THE PRESIDENT** *By Debbie Morrow*

Hi All,

We had our first meeting 2nd Saturday at Just off Main and we had a good turn out, even with the Grapefest festival going on. I am hoping that October will be an even better turn out. We are looking for another location in the area and are hoping to keep it on the 3rd Sunday like it was before. Allison Archer one of our members has been looking a lot and keeping me up to date on her findings. Thank you for all of your effort Allison. At this time it's still 2nd Saturday October 12 at just off Main in Grapevine.

Fall is upon us and the Texas weather is beautiful. It's a good time to hit the bluegrass circuit. We have a lot of events coming up.

One of my favorites is the Bloomin Bluegrass festival and Chili Cook -off, in Farmers Branch October 18-19th.

It's one of my favorite outside events because the weather is usually great and it's a big open area with lots of room to lay out a blanket on the grass and pull up the lawn chairs and just relax and let music surround you. The whole family, kids, grand kids friends and family can come and it's free admission. How great is that? I hope to see you there. I'll be there right after work on Friday and all day Saturday.

On a different note I want to ask if anyone is thinking about taking over the publishing of our newsletter. Dennis is no longer going to be doing this after the December newsletter which has been announced. We haven't had a single person inquire that I am aware of and this is really important. I hope we hear from someone about this soon.

As always, My prayer is that our club will be around many more generations and our Grandchildren will be playing music together. My vision for the club going forward is Good Bluegrass Music, Good Bands, Good Jams, Good Fellowship and of course Great Food. God Bless, Deb



Southwest Bluegrass Club  
Masters of Bluegrass Concert - November 16th

The Southwest Bluegrass Club has secured two nationally recognized bands of enormous accomplishment for the November 16, 2013 McKinney Performing Arts Center concert  
**All tickets are reserved and seating is limited, so please buy your tickets today.**

[tickets.mckinneyp performingartscenter.org](http://tickets.mckinneyp performingartscenter.org)

or

**214-544-4630 (M-F, 9-5)**

note: **IBMA** = International Bluegrass Music Association

**SPBGMA** = Society for the Preservation of Bluegrass Music in America

**GMA** = Gospel Music Association

**Lou Reid and Carolina**  
**(Union Grove, North Carolina)**

Lou Reid is a former winner of the IBMA Emerging Artist of the Year Award and he is arguably the most recognizable voice in Bluegrass music. Lou started as a bass player with Doyle Lawson and Quicksilver, played banjo on the first #1 Country hit to feature a banjo (Ricky Skagg's *Thank God I'm A Country Boy*), played guitar and sang high tenor with The Seldom Scene, and currently plays mandolin and sings lead both with the Seldom Scene and with his own band Lou Reid and Carolina.



Lou Reid and Carolina won the 2010 SPBGMA Song of the Year for the song *Amanda Lynn*, and in 2011 they received a GMA Dove Award's Song of the Year nomination for the song *It's So Hard To Stumble* (when you're down on your knees).

The band has had three #1 and many other top hits on the Bluegrass charts.

The group has recently added guitarist extraordinaire and great bass/baritone singer Skip Cherryholmes to the group. Skip's family band The Cherryholmes were IBMA Entertainers of the Year in 2005 and had several Grammy nominations for Best Bluegrass Album (2006, 2007, and 2008).

**The Byron Berline Band (Guthrie, Oklahoma)**

The band provides an upbeat and creative blend of Bluegrass, Western Swing, and more.

Byron's accomplishments include being a three-time National Fiddle Champion as well as a member of three-time IBMA Instrumental Group of the Year (California). He was nominated for two Grammy Awards for his solo album Fiddle and a Song.

Byron's early career included playing fiddle with bluegrass legends such as Bill Monroe, Dillard and Clark, and Country Gazette. His long list of performing and recording credits includes The Rolling Stones, The Eagles, The Band, The Byrds, Elton John, Alabama, Mary Chapin Carpenter, The Flying Burrito Brothers, Rod Stewart, John Denver, Earl Scruggs, Emmylou Harris, Tammy Wynette, Mason Williams, Bob Dylan, Willie Nelson and Vince Gill. He also has extensive television and movie sound track credits and has appeared in Star Trek, Blaze, Back To The Future III, and Basic Instinct.

The rest of his musicians are excellent as well and have won awards and played with many noted bands and stars in the industry.

A flyer (SEE PAGE 8) for this concert is included in this newsletter, and we encourage everyone to buy your tickets early and enjoy a really great show.

**If you would like to volunteer to help our club the day of the show, please contact Bill Kline at 903-337-0950. We really could use some help.**



**CLUB NEWS**

**NEW APPOINTED DIRECTOR -**

***Buzz Busby** has been confirmed as Director by the General membership at the September meeting. .*

---

**Dennis Hillery Resigning as Newsletter Editor**

**Effective December 2nd**

I have been the Bluegrass Reflections Newsletter editor since February 2006 and, except for a year and a half; have published 80 newsletter issues including this issue. The December 2013 issue will be the last one I will do. I am resigning as Editor with December 2nd as the official resignation date. The December issue will have been published and sent by that date. My decision to relieve myself of that responsibility is final.

**We now need to have you to share your talents and take over the Editor position.** For whoever does agree to take the job of Editor, if they need or want my help, I'll be willing to show them how I produce the newsletter and publish it. All that's needed to do the job is some familiarity with the Microsoft Word program.

All members are encouraged to step forward and volunteer to take on this job of Editor. If you know of someone who might be interested in volunteering, please talk to them and ask them to step forward and check out whether they might take on the job. If you like receiving a newsletter like this, you get to receive it only if someone takes over the job. If there's no Editor, there's no Newsletter. There's a saying about "no free lunches"...

Dennis's countdown to Editor Retirement, OCTOBER ISSUE, NOVEMBER ISSUE, and DECMEBER ISSUE. **JUST 2 MORE ISSUES** until my retirement as Editor.

***You can contact any of the Officers or Staff listed on page 2 to volunteer.***

**TICKETS AVAILABLE FOR OUR NOVEMBER 16th SHOW**

Tickets for the Southwest Bluegrass Club November 16th show Masters of Bluegrass featuring Lou Reid and Carolina and the Byron Berline Band are now on sale.

**Approximately 100 of the 427 seats are already sold** and we recommend you order early to insure you get the best seats (all seats are reserved). To obtain tickets:

Go to: [tickets.mckinneyperformingartscenter.org](http://tickets.mckinneyperformingartscenter.org)

Or call: [214-544-4630](tel:214-544-4630)

**CLUB NEWS CONTINUED ON PAGE 15**

## **UPDATE AND REQUEST FOR OUR NOVEMBER 16TH SHOW**

Tickets for the Southwest Bluegrass Club November 16th show Masters of Bluegrass featuring Lou Reid and Carolina and the Byron Berline Band are now on sale. Approximately 100 of the 427 seats are already sold and we recommend you order early to insure you get the best seats (all seats are reserved). To obtain tickets:

Go to: *[tickets.mckinneyperformingartscenter.org](http://tickets.mckinneyperformingartscenter.org)*

Or call: *214-544-4630*

**It will be a great concert, but will only be a success if we get the support from all members of our club.**

Buy a ticket for you, members of your family and friends. These are two bands who will not only please the hardcore Bluegrass enthusiast, but will also please general audiences. They are both incredible and offer lots of variety.

Usually people who are not hardcore Bluegrass enthusiasts don't want to sit thru five bands and ten hours of music. This concert is different. Our concert should only last around three hours. It is my opinion that those who attend out of curiosity about our music will not get bored, but leave with a smile on their face and a desire to listen to more of our music and attend more of our events. This a chance to bring those who normally would not want to go, with the confidence that they will thank you for sharing it with them. Take advantage of this, support your club, and see a fantastic show at the same time.

Spread the word. Print off a flyer and share it with others. I have already bought nine tickets myself.

If you are attending and want to help out at the show with ticket collection and ushering, please call or email me.

Thanks.

-Bill Kine

[cadubrin@sbcglobal.net](mailto:cadubrin@sbcglobal.net)

903-337-0950

## In Memory of Don Humphery

**Don Humphery**, 73, passed away September 17 in Glen Rose after a long illness. Don was born in Paris, Texas and migrated to Glen Rose in 1986. He worked at Oakdale park for about two years before changing to hospital maintenance. He retired from Walls Hospital in Cleburne in 2004. He was married to his wife B.J for 54 years and had 3 boys.



Don was an avid Bluegrass fan. He played the banjo and mandolin. We was in the "Outcast Bluegrass" band of Pittsburg, Tx. before coming to Glen Rose. He joined the "Friends and Neighbors" band and played with them until the group broke up several years later. I remember Don and the group opening for Mac Wiseman at the amphitheater in Glen Rose years ago. His last group was "Southridge" until he was unable to play.

You could always find Don in a jam session. His last one was in his hospital room just 2 days before he died. You could hear Roger Starns banjo ringing all the way down the hall. What a send off!

*Contributed by Frank Simurdak*

## Friday Bluegrass Night In Royse City

The second Friday of each month at "The Well" coffee shop  
at 103 East Main Street - Royse City - 972-635-6852

Admission is FREE!

The host band is **Blackland Grass**, but we encourage other bluegrass musicians to enjoy our open microphone segment and perform on stage! Call ahead to register your group, or just show up and take the stage!

For more information call Jim Rozell (972 800-2527) or Phil Shaner (214 766-7823) also our web site is  
[BlacklandGrass.com](http://BlacklandGrass.com)



## COMPTON & GRIER

October 3, 2013 7:00 pm

1st United Methodist Church: Leonard Chapel

800 W. 5th, Fort Worth, TX 76102

\$20.00 pre-sale; \$25.00 door

contact: [robertjustinholt@yahoo.com](mailto:robertjustinholt@yahoo.com)

Together, these two supremely talented pickers play with a rapport that is nothing short of uncanny. This is partly because the quality of musicianship is so high. But an even larger reason is that the picking of Mike Compton and David Grier (like that of their respective mentors) is so consistently unpredictable. The unexpected surprise may come from the way Compton takes one of his "Billisms" (as he refers to his [musical] quotes from Monroe) and stands it on its head or it may come from one of Grier's startling melodic leaps or chokes. Whatever its twists and turns, though, this is music that shows subtlety and sophistication.

[www.mikecompton.net](http://www.mikecompton.net)

[www.davidgrier.com](http://www.davidgrier.com)



**FREE**



**BLOOMIN'**  
**BLUEGRASS FESTIVAL**  
AND CHILI COOKOFF



**Friday & Saturday October 18-19, 2013**  
**Farmers Branch Texas Historical Park**

**Suzy Bogguss ♦ Travelin' McCourys ♦ Sierra Hull**  
**The Boxcars ♦ Russell Moore & Illrd Tyme Out**  
**Rambling Rooks ♦ The Spinney Brothers**  
**Gold Heart ♦ The Herrins**

*Free Admission, no ticket required*

Two days of great music, chili, and beautiful flowers under the Texas sky!  
Bring your blankets and lawn chairs!

**Festival hours**  
Friday 4:30p - 10p  
Saturday 10:30a - 10p.

**Farmers Branch Historical Park**  
2540 Farmers Branch Ln  
Farmers Branch, Texas 75234

Only 15 minutes from D/FW Airport!

**Discounted Festival Room Rates!**  
**RV parking available.**

Check our website at:

BluegrassHeritage.org for more details about special deals on hotel rooms.

Artists and schedule subject to change without notice.

**BluegrassHeritage.com**  
info@BluegrassHeritage.com



This event is brought to you by the City of Farmers Branch, Texas and the Bluegrass Heritage Foundation.



Spring Creek Bluegrass Club  
**BLUEGRASS MUSIC WEEKEND**  
 October 24, 25, 26, 2013

At **COUSHATTE Recreation Ranch • Bellville, Texas**

Lots of jamming • Shade Trees and Good Campsites • **Door Prizes**  
**Good Food Vendors • Arts & Crafts • No Pets in Concert or Vending Area • Proper Dress Required**  
 Bring covered dish for **Hobo Stew-Wed** • Shuttle service provided from parking lot to stage area  
**Rain or Shine Event - In case of bad weather show will be moved inside.**  
 Not responsible for accidents or weather

**ADMISSION**

Per person  
**Advance - 3 Day - \$40.00**  
 When Received by Oct. 15  
 3 Day - **At Gate - \$45.00**  
**Thursday ..... \$10.00**  
**Friday ..... \$20.00**  
**Saturday ..... \$20.00**  
 (Tax included)  
 Children Under 14 FREE

**NO ADMISSION Without Ticket**

**MUSIC STARTS**

Thur. 6:00 pm • Fri. 1:00 PM • Sat. 1:00 pm  
 Open Stage 10:00am Saturday

**OVER NIGHT CAMPING**

Most w/Water/Elect/Sewer  
**\$20.** - 30 amp / 50 amp  
**NO Reservations**  
 \$6. Rough Camping  
Camping fees collected at the gate only.

**LODGING IN AREA**

Ask for **BLUEGRASS RATE**

Holiday Inn Exp - Sealy (979) 877-0700  
 American Best Value-Sealy(979) 885-3707  
 Super 8 - Sealy (979) 885-2121

e-mail: [bluegrass221@peoplepc.com](mailto:bluegrass221@peoplepc.com)  
[www.springcreekbluegrass.com](http://www.springcreekbluegrass.com)

**Family Bluegrass Entertainment**

**Bluegrass Martins** -Jefferson City,Mo (Fri-Sat)  
**The Farm Hands** -Northport, AL (Fri-Sat)  
**Magnolia Drive** -Madison, Ms (Fri-Sat)  
**Volume Five** -Booneville, Ms (Fri-Sat)  
**The Saltgrass Band**-Lake Jackson, Tx (Fri-Sat)  
**Lonestar Bluegrass** -Sugar Land, TX (Fri)  
**Greer Family Band** - Burton, Tx (T)  
**Buffalo Nickle** - Sugar Land, Tx (T)  
**Sowell Family Pickers**- Hempstead, TX (T)  
**Texas Olde Tyme Bluegrass**- Magnolia, TX (T)

Sound by: **Mary Marshall** Emcee:  
 Nashville, AR **Buddy Brockett**

**FOR TICKETS & INFORMATION**

**Spring Creek Bluegrass Club**  
 % Buddy or Carolyn Brockett  
 PO Box 1294 - Bellville, TX 77418  
**(979) 865-5250 /979 877-9526**  
 Coushatte Ranch: (979) 885-8909

Bring Your  
 LAWN CHAIRS

BELLVILLE

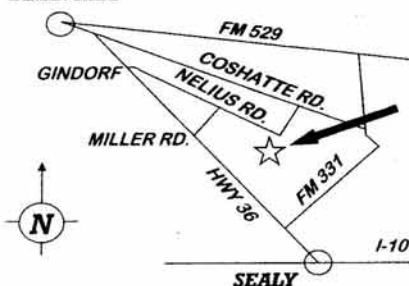

**Coushatte  
 Recreation Ranch**  
 On Nelius Road  
 between  
 Sealy and Bellville

Absolutely **NO Alcoholic Beverages** Allowed • Violators Will be Forced to Leave • **NO Refunds**

The  
Southwest Bluegrass Club  
Presents

# MASTERS OF BLUEGRASS

On Sale Now  
All Seats Reserved \$20



For Best Available Seats  
Order Today



## LOU REID AND CAROLINA

2010 SPBGMA Song of the Year  
-Amanda Lynn-  
Dove Song of the Year Award Nominee 2011  
-It's So Hard to Stumble-  
Three #1 and Many Other Top Hits  
Lou Reid is arguably the most  
recognizable voice in Bluegrass music  
Former winner of the the  
IBMA Emerging Artist Award

## The BYRON BERLINE BAND

An upbeat and creative blend of Bluegrass, Western  
Swing and more.

Byron has been a member of many top bands and  
has recorded with the Rolling Stones,  
Bob Dylan, Elton John, Alabama, Emmylou Harris,  
Tammy Wynette, The Eagles and many, many more.

His past accomplishments also include:

3-time National Fiddle Champion  
3-time IBMA Instrumental Group of the Year  
His solo album "Fiddle and a Song" was Nominated  
for 2 Grammy Awards



MCKINNEY PERFORMING ARTS CENTER

Doors Open  
5:30PM

# NOVEMBER 16, 2013

Show Starts  
6:00PM

111 N TENNESSEE ST

MCKINNEY, TEXAS

[tickets.mckinneyp performingartscenter.org](http://tickets.mckinneyp performingartscenter.org) (214-544-4630)



This project funded in part by the City of McKinney through  
the McKinney Arts Commission, and by Staff Force, Inc



**Bluegrass Calendar of Special Events**

*Please Note: The following Events are believed to be accurate, BUT you are advised to verify with the contacts.*

**GO TO BLUEGRASSDOG.COM TO FIND FLYERS FOR THESE EVENTS**

**OCTOBER – 2013**

**October 3** Compton and GrIer Show --- SEE PAGE 8 FOR FLYER

**Oct 02-05**, Oak Grove LA – Annual North LA Fall Bluegrass Festival – **The Thomas Jason Lingo Community Center** – 10284 Hwy 17 South – 318-428-5282 – R V Camping – On Site Motel Oak Grove Inn & Suites, 866-806-8911 or 318-428-2088 Email: [Needfoundation\\_communitycenter@yahoo.com](mailto:Needfoundation_communitycenter@yahoo.com) - (Note the underscore in the e-mail address.)

**Oct 03**, DeRidder LA – 87<sup>th</sup> Annual Beauregard Parish Fiddle Contest – Ron Yule - 337-463-5884 – Seniors come in Free – Entertainment starts around 8AM – Fiddle Contest around 10AM to Noon

**Oct 04-06**, Guthrie OK – Oklahoma’s International Bluegrass Festival – 405-282-4486 or 877-203-1206 - [www.oibf.com](http://www.oibf.com)

**Oct 03-05** Glen Rose TX – **Paluxy River Fall Bluegrass Festival** – City of Glen Rose New Oak Dale Park - Reservations 254-897-2321 - [www.oakdalepark.com](http://www.oakdalepark.com) - [www.GlenRoseBluegrass.com](http://www.GlenRoseBluegrass.com) - More on Glen Rose lodging & Events: [www.glenrosetexas.net](http://www.glenrosetexas.net)

**Oct 05**, Del City OK – OBC Bluegrass Music Concert - Kerr Junior High – 2300 S Linda Lane – Jam 5:30 PM – Stage Show starts 7PM - 405-760-3064 – \$6.00 (Members \$5.00) Web: [www.okbgc.org](http://www.okbgc.org) –

**Oct 07-12**, Vinton LA - A Week Long Camp & Jam – Niblett's Bluff Park -3409 Niblett's Bluff Road – 70668 –Call 337-589—7117) – For Festival Info call 337-513-2703 <http://www.niblettsbluffpark.com> –

**Oct 09-12**, Waldron AR – Turkey Track Bluegrass Festival – Bill or Linda Lovett – 479-637- 3717 – Hwy 250, 10 miles S. E E-mail: [turkeytrack@hughes.net](mailto:turkeytrack@hughes.net) Web: [www.turkeytrackbluegrass.com](http://www.turkeytrackbluegrass.com)

**October 11** Quitman TX **2<sup>nd</sup> Friday's** Bluegrass Acoustical Jam, Quitman Public Library 202 East Goode Street (Hwys 154 & 37) 5pm – 9pm, call 903-952-8305 or 903-975-5745 <http://www.quitmanlibrary.org/>

**October 12** Venus TX **2<sup>nd</sup> Saturday's** Venus BG Opry, show & jam, Venus Civic Center Bldg., 7-10 PM. Dale Brawner: 972-935-4525

**October 12** Grapevine TX **2<sup>nd</sup> Saturday's** Southwest Bluegrass Club sponsored Jam at the “Just Off Main” Café at 113 E. Texas St. Jam from 11:45 AM to 4 PM. The link is <http://www.meetup.com/Bluegrass-Music-Jams-and-Shows/> or call Bill at 903-337-0950.

**Oct 11-12**, Fayetteville, Texas - Texas Pickin' Park – Free Jamming On The Square – Fri: 5:00PM – Saturday: All Day - Info: 512-415-3177 – [Info@texaspickinpark.com](mailto:Info@texaspickinpark.com) - Web [www.texaspickinpark.com](http://www.texaspickinpark.com) (Jams run April through November.

**Oct 12**, Ragley LA – 2nd Saturday Bluegrass Jam- Lone Pine Music Park - Doors Open 11AM for Jamming – Stage Show starting at 5PM – Camping Available \$12 –Info: Slim Alston. 337-200-0737 – Mancel Reeves 337-749-2683 – E-Mail [calston@centurytel.net](mailto:calston@centurytel.net)

**Oct 12**, Del City OK - Bluegrass Workshop/Concert/Jam -- GOBMS -- Oklahoma Country-Western Museum & Hall of Fame -- 3925 SE 29 -- Jamming 5 PM-9:15 PM -Concert 6:30 PM (3 Bands On stage -- Admission \$6.00, (Members \$5.00); 12 & under, Free -- 405-677-7515 or 405-308-3595 -- [www.gobms.org](http://www.gobms.org)

**Oct 13-19**, Wynnewood OK – (Arbuckle Mountain) 37620 County Rd 1693 – Fall Jam – Pot Luck – Band Scramble – Drawings – Jamming All Week- 405-665-5226 – E-Mail: [arbucklemtpark@gmail.com](mailto:arbucklemtpark@gmail.com) Web: [www.arbucklemtbluegrasspark.com](http://www.arbucklemtbluegrasspark.com) -

**October 18** Lillian TX **3<sup>rd</sup> Friday's** (January – November )BG Show & Jam, Lillian First Baptist Church, 1055 CR 519,. 7:00 PM, \$5 donation. 817-929-8391 [ntbbbluegrass.com](http://ntbbbluegrass.com)

**October 19** Glen Rose, TX - **Every Third Saturday**, Paluxy River BMA, **Jam (3 pm)** and **Show (at 6:30)** at Oakdale RV Park, 1019 Northeast Barnard St, Frank Simurdak **817-776-2131** email (Frank Simurdak) [fsimurdak@gmail.com](mailto:fsimurdak@gmail.com)

**Oct 19**, League City TX - Bay Area Bluegrass - 300 Walker St. 5PM Jam, 6:30PM Stage Show –Rick Kirkland, Pres. 281-488-2244 - Publicity, Darryl O’Bryant –[liv.2.fish@hotmail.com](mailto:liv.2.fish@hotmail.com) – Web: [www.bayareabluegrass.org](http://www.bayareabluegrass.org)

**Oct 19-20**, Farmers branch TX – **Bloomin' Bluegrass Festival and Chili Cookoff** –  
F B Historical Park – 2540 Farmers Branch Lane - Free Admission – Fri, 5 to 10P –Sat Noon to 10PM -  
[www.bluegrassheritage.org](http://www.bluegrassheritage.org) for details

**Oct 20-26**, Adona AR – Fall Bluegrass Jam - Cypress Creek Park - 501-662-4918 –  
<http://www.cypresscreekpark.com/>

**Oct 24-26**, Woodville TX – Triple Creek RV Music Park – Bluegrass Week End 409-283-3799 – Six miles  
East of Woodville on FM 1746 then three miles North on PR-8335 – Other events on other week ends – Visit  
[www.triplecreekrv.com](http://www.triplecreekrv.com) for more info.

**Oct 24-26**, Bellville TX – Spring Creek Bluegrass Club *Bluegrass Weekend* Buddy or Carolyn Brockett, 979-865-  
5250, 979-877-9526, Coushatte Ranch 979-885-8909 [www.springcreekbluegrass.com](http://www.springcreekbluegrass.com) **FLYER ON PAGE 10**

**Oct 28**, Paragould AR – KASU's Bluegrass Monday – Collins Theatre – 120 West Emerson St - Marty Scarbrough,  
870-972-2367 or [mscarbro@asate.edu](mailto:mscarbro@asate.edu) – Show Starts 7PM -\$5.00 donation given 100% to the bands - Featured Band:  
**The Punches Family**

## **NOVEMBER – 2013**

**November 16**, McKinney TX, *the Southwest Bluegrass Club presents the*  
**Masters Of Bluegrass Show at the McKinney Performing Arts Center, 111 N. Tennessee St.,**  
**McKinney featuring Lou Reid and Carolina and the Byron Berline Band**  
for tickets call 214-544-4630 and on line at [tickets.mckinneyperformingartscenter.org](http://tickets.mckinneyperformingartscenter.org)  
**See Flyer on page 11**

**Nov 02**, Del City OK – OBC Bluegrass Music Concert - Kerr Junior High 300 S Linda Lane – Jam 5:30 PM – Stage  
Show starts 7PM - 405-760-3064 – \$6.00 (Members \$5.00) Web: [www.okbgc.org](http://www.okbgc.org) –

**Nov 04-09** Ragley LA – Camp & Jam – Lone Pine Music Park – 9271 US 190 – Jamming all  
week indoor and or outdoor. Stage Show on November 9<sup>th</sup> at 5PM. Mancel Reeves, 337-749-2683 - **Free Admission**  
Hookups Available - Donations gladly accepted to help cover expenses.

**Nov 07-09**, Mountain View AR – Fall Bluegrass Festival – Ozark Folk Center - 870-269-2542 or 870-269-2704 –  
[www.mountainview-bluegrass.com](http://www.mountainview-bluegrass.com)

**November 8** Quitman TX **2<sup>nd</sup> Friday's** Bluegrass Acoustical Jam, Quitman Public Library 202 East Goode Street  
(Hwys 154 & 37) 5pm – 9pm, call 903-952-8305 or 903-975-5745 <http://www.quitmanlibrary.org/>

**November 9** Venus TX **2<sup>nd</sup> Saturday's** Venus BG Opry, show & jam, Venus Civic Center Bldg., 7-10 PM. Dale  
Brawner: 972-935-4525

**November 9** Grapevine TX **2<sup>nd</sup> Saturday's** Southwest Bluegrass Club sponsored Jam at the "Just Off Main" Café at  
113 E. Texas St. Jam from 11:45 AM to 4 PM. The link is <http://www.meetup.com/Bluegrass-Music-Jams-and-Shows/> or call Bill at 903-337-0950.

**Nov 08-09**, Fayetteville, Texas - Texas Pickin' Park – Free Jamming On The Square –Fri: 5:00PM – Saturday: All  
Day - Info: 512-415-3177 -[Info@texaspickinpark.com](mailto:Info@texaspickinpark.com) - Web [www.texaspickinpark.com](http://www.texaspickinpark.com) (Jams run April through  
November

**Nov 09**, Del City OK - Bluegrass Workshop/Concert/Jam -- GOBMS -- Oklahoma Country-Western Museum & Hall  
of Fame -- 3925 SE 29 -- Jamming 5 PM-9:15 PM -Concert 6:30 PM (3 Bands On stage -- Admission \$6.00, (Members  
\$5.00); 12 & under, Free -- 405-677-7515 or 405-308-3595 -- [www.gobms.org](http://www.gobms.org)

**November 15** Lillian TX **3<sup>rd</sup> Friday's** (January – November )BG Show & Jam, Lillian First Baptist Church, 1055 CR  
519,. 7:00 PM, \$5 donation. 817-929-8391 [ntbbbluegrass.com](http://ntbbbluegrass.com)

**November 16** Glen Rose, TX - Every Third Saturday, Paluxy River BMA, Jam (3 pm) and Show (at 6:30) at Oakdale RV Park, 1019 Northeast Barnard St, Frank Simurdak 817-776-2131 email (Frank Simurdak) [fsimurdak@gmail.com](mailto:fsimurdak@gmail.com)

**Nov 16**, League City TX - Bay Area Bluegrass - 300 Walker St. 5PM Jam, 6:30PM Stage Show –Rick Kirkland, Pres. 281-488-2244 - Publicity, Darryl O’Bryant – [liv.2.fish@hotmail.com](mailto:liv.2.fish@hotmail.com) – [www.bayareabluegrass.org](http://www.bayareabluegrass.org)

**Nov 21-23** Woodville TX – Triple Creek RV Park Bluegrass Weekend – 409-283-3799 – [www.triplecreekrv.com](http://www.triplecreekrv.com)

**Nov 25**, Paragould AR – KASU’s Bluegrass Monday – Collins Theatre – 120 West Emerson St - Marty Scarbrough, 870-972-2367 or [mscarbro@asate.edu](mailto:mscarbro@asate.edu) – Show Starts 7PM

**Nov 30**, Del City OK – 5th Saturday Bluegrass Gospel Concert/Jam -- GOBMS --Oklahoma Country-Western Museum & Hall of Fame -- 3925 SE 29 --Jamming 5 PM-9:15 PM -- Concert 6:30 PM (3 Bands On stage – Admission \$6.00, (Members \$5.00); 12 & under, Free -- 405-677-7515 or 405-308-3595 - [www.gobms.org](http://www.gobms.org) –

## DECEMBER – 2013

**Nov 24-Dec 01** Independence LA - 22nd Annual 'Christmas in The Pines' - Apostolic Campground - 5305 Cooksey Lane - I-55 Exit 41 (Hwy 40) - Butch, 985-608-1790 –225-209-5387

**Dec 07**, Del City OK – OBC 44th Christmas Anniversary Show - Kerr Junior High – 2300 S Linda Lane – Jam 5:30 PM – Music Begins at 5:30PM - 405-760-3064 – Web: [www.okbgc.org](http://www.okbgc.org)

**Dec 13-14**, Fayetteville, Texas - Texas Pickin’ Park – No Jams December through March Starts back 2<sup>nd</sup> week in April 2013

**Dec 14**, Arcadia LA – 2<sup>nd</sup> Saturday Bluegrass Show – Old Railroad Depot/Museum – 1 to 5PM - All bands or performers interested in performing, please contact Aaron Carr at 318-355-6449 or Email [aocarr@att.net](mailto:aocarr@att.net)

**Dec 14**, Ragley LA – 2nd Saturday Bluegrass Jam- Lone Pine Music Park - Doors Open 11AM for Jamming – Stage Show starting at 5PM – Camping Available \$12 – Info: Slim Alston. 337-200-0737 – Mancel Reeves, 337-749-2683 e-mail: [calston@centurytel.net](mailto:calston@centurytel.net)

## CLUB NEWS -- Continued



### For the Month of August, 2013

<b><u>Total Cash in Hand</u></b>		
<b><u>On August 1, 2013</u></b>		<b><u>\$ 7,936.11</u></b>
<hr/>		
<b><u>INCOME</u></b>		
Membership Dues	\$	125.00
Newsletter Ad	\$	50.00
Interest Income	\$	.07
<b><u>TOTAL INCOME</u></b>		<b><u>\$ 175.07</u></b>
<hr/>		
<b><u>EXPENSES</u></b>		
Tripple L Band 8/18 mtg	\$	265.00
<b><u>TOTAL EXPENSES</u></b>		<b><u>\$ 265.00</u></b>
<hr/>		
<b><u>Total Cash in Hand</u></b>		
<b><u>as of August 31, 2013</u></b>		<b><u>\$ 7,846.18</u></b>

Respectfully submitted, *Phyllis Hillery*, Treasurer

Secretary Vacancy

[We now need a Volunteer to step forward and do your part by taking over the Secretary position.](#) [You can contact any of the Officers listed on page 2 to volunteer](#)

---

Chrystal Opry House Jam Change

[From Annette Hayes](#), We have moved the jam to the [first Saturday of the Month at 5 pm](#). We also encourage folks to participate in an open mic at 6:30 and then our regular First Saturday Bluegrass show is at 7 o'clock. Our line-up for First Saturday Shows is as follows:

October 5—Copper Canyon

October 24—Special Event—Little Roy & Lizzie Show

November 2—Nickelville Road

December 7—Melody Ranch Ramblers

[www.chryystalopryhouse.com](http://www.chryystalopryhouse.com) 903-546-6893

1977 White Mound Rd, off Hwy 902, Sherman, TX 75090

---

***SEE THE SPECIAL EVENTS LISTINGS FOR OCT 3<sup>RD</sup>***  
***and the Flyer on the next page***

Mike Compton and David Grier Special Performance

*October 3<sup>rd</sup> at 7 pm at 1<sup>st</sup> United Methodist Church, Leonard Chapel, 800 W. 5<sup>th</sup>, Fort Worth, TX 76102*

[Contact robertjustinholt@yahoo.com](mailto:robertjustinholt@yahoo.com)

Together, these two supremely talented pickers play with a rapport that is nothing short of uncanny. This is partly because the quality of musicianship is so high. But an even larger reason is that the picking of Mike Compton and David Grier (like that of their respective mentors) is so consistently unpredictable. The unexpected surprise may come from the way Compton takes one of his "Billisms" (as he refers to his [musical] quotes from Monroe) and stands it on its head or it may come from one of Grier's startling melodic leaps or chokes. Whatever its twists and turns, though, this is music that shows subtlety and sophistication.

REFLECTIONS NEWSLETTER ADVERTISING RATES - MONTHLY

FULL PAGE -- \$25 \*\*\*\*\* HALF PAGE -- \$20 \*\*\*\*\* QUARTER PAGE -- \$15

Copy deadline is the 20<sup>th</sup> of the month prior to the publication cover date.

Make checks payable to: Southwest Bluegrass Club.

Send payment and electronic copy to: Editor, 143 Pelican Cove Drive, Rockwall, TX 75087

email copy to [dhillery1@gmail.com](mailto:dhillery1@gmail.com)

**PUBLISHER'S COPY PROTECT CLAUSE**

Advertisers and advertising agencies assume liability for all content of advertisements printed and also assume responsibility for any claims arising therefrom made against the publisher. We reserve the right to reject any advertising or copy which is not in keeping with the publication's standards.

SOUTHWEST BLUEGRASS CLUB MEMBERSHIP APPLICATION

Membership dues, including access to the monthly publication, Bluegrass Reflections, is \$25 per year per family. This includes a spouse / significant other and all children under the age of 18.

MEMBER NAMES: (Please Print)	NEW MEMBERSHIP _____	<input type="checkbox"/>
.....	RENEWAL MEMBERSHIP _____	<input type="checkbox"/>
.....	CHANGE OF ADDRESS (EMAIL) _____	<input type="checkbox"/>
.....	DATE OF ABOVE _____	<input type="checkbox"/>

Email address.....

NEWSLETTER WILL BE SENT BY EMAIL

Postal address, street.....

City.....state..... zip.....

Phone .....

Would you like to make a donation to the Club's Scholarship Fund?

If so, enter amount..... \$ \_\_\_\_\_

Membership Dues ..... \$25

Total amount paid..... \$ \_\_\_\_\_

Make check payable to **Southwest Bluegrass Club**

Mail Payment to: **Southwest Bluegrass Club**  
143 Pelican Cove Dr.  
Rockwall, TX 75087

Email to [dhillery1@gmail.com](mailto:dhillery1@gmail.com)